



PAVER  
BF 223 C

## PERFORMANCE DATA



# Technical Data

Shipping dimensions in m<sup>3</sup>

BF 223 C

11,015

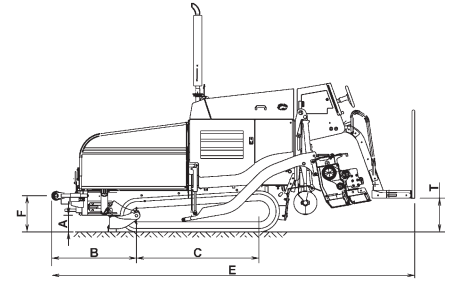
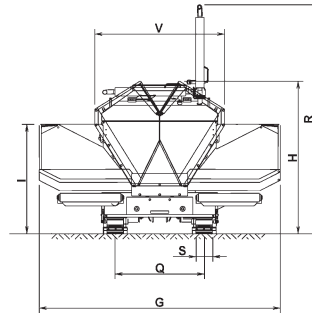

**Loading measurements** L x W x H  
**BF 223 C** 4.065 x 1.430 x 1.895

## Standard equipment

- Individual control of hopper wings
- Adjustable truck bumper rollers
- Reversible scraper belt, electro-mechanically controlled
- 2 reversible augers, electromechanically controlled
- Mechanical auger height adjustment
- Mechanical walk board adjustment
- Vibration setting infinite (960-3600 rpm)
- Crawler track with PLC travel, control and braking system
- 1 working speed range, 1 fast travel speed range
- 200 mm floor plates with rubber pads, individually screwed
- Diesel engine, 4 cylinder, 37.3 kW
- Electrically heated HF hydraulic screed with 1.4 - 2.6 m placing width
- Fully automated screed heating (electric heating)
- Hinged and telescopic food walk

## Optional equipment

- Screed extensions BF 223 C electric screed: 3300 mm, 4000 mm
- Hydraulic auger height adjustment.
- Cleaning system with hose reel, pump and tank
- Reduction pads 500 mm
- Levelling systems: Height and lateral sensing with ultrasonic or mechanical sensors

## Measurements

in mm	B	C	E	F	G	H	I	Q	R	S	T	V	Z
<b>BF 223 C</b>	1020-1100	1471	4365-4445	435	2905	1895	1320	1080	2755	200	405	1429	5100

## Technical data

Max. Production.....	t/hr	200
Diesel engine.....	Type	Perkins PK404D-22
Output (ISO 3046/1).....	kW (hp)	37.3 (51) at 2800 r.p.m.
Number of cylinders .....		4
Motor cooling .....		Water cooling
Crawler track.....	mm	200 x 1471
		Rubber-BPL
Working speed .....	m/min	0-29
Drive speed .....	km/h	0-4.1
Hopper volume .....	m <sup>3</sup>	2.8
Scraper belt width .....	mm	440
Auger diameter .....	mm	280
Diesel tank capacity .....	l	110
Hydraulic tank volume .....	l	75
Screed type.....		HF
Screed compaction.....		Vibration
Screed heating.....		electric
Width of the basic screed .....	m	1.40-2.60
Max. placing width .....	m	4.00
Weight of the basic screed.....	kg	640
Smoother plate width/thickness .....	mm	245/10
Operating weight.....	kg	5,100
Straight crossfall .....	%	-2 to +2,5
Max. effective amplitude .....	mm	200

## BOMAG BF 223 C

Technical modifications reserved. Machines may be shown with options.



PRE 001 07 401

250513 Sa05

**BOMAG**  
 Hellerwald  
 D-56154 Boppard  
 Postfach 5162  
 D-56149 Boppard  
 Tel. (0)6742 - 1000  
 Fax (0)6742 - 3090

